



User Manual

Android car navigation

★Main interface

When powered on, the system will enter the main interface by default, under other function interface, touch the Home button on the panel to enter main menu. Tray icon including Navi, Radio, Bluetooth, Music, Video, Setting.

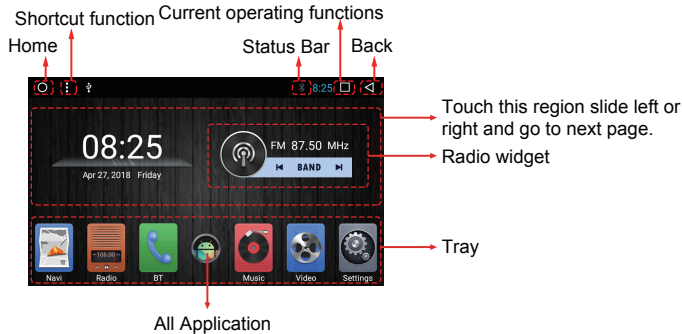

When powered on, the system will enter the main interface by default.



Pull-down menu

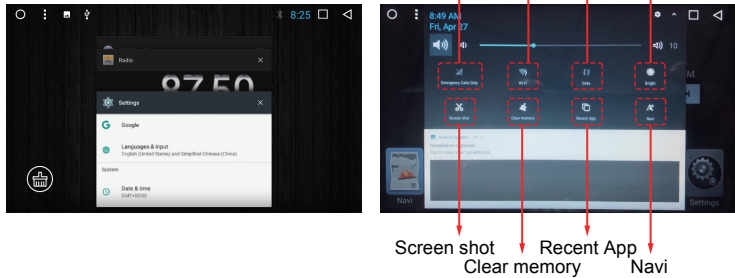

★ Radio operation

Click “” icon or Radio widgets on the main menu to enter Radio interface.

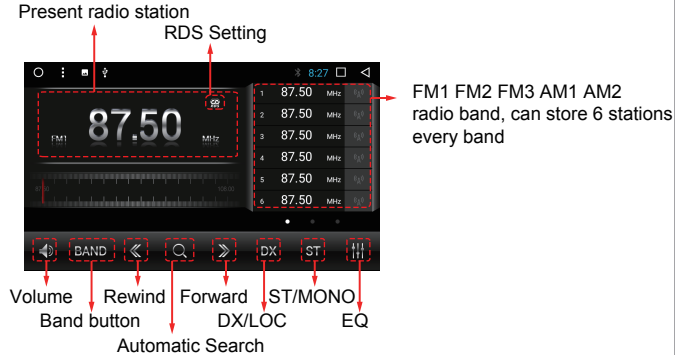

1. RDS: RDS is a special wireless radio system developed by BBC, called “Wireless data broadcasting system”, which only could be used in Europe area.

2. AF: Replacement frequency table ,AF table shows that inside the same or a neighboring receiving zone ,it broadcasts the information of same program’s each transmitter. The receiver is stored and reduce frequency of search and replace of time,which is particularly useful for mobile reception.

3. TA: Traffic Announcement identification, indicate whether being broadcast traffic automatically switching to the program of traffic bulletin after broadcasting, back to its original working condition

4. PTY: Type of program is a program type identification code , accompanied by every program and transmit, indicating what kind of radio program is being broadcast in 31 genera Click here record it.

★Bluetooth operation

On main menu, click “” to enter bluetooth interface, shown as below:

1 Turn on mobile phone's Bluetooth and Bluetooth device searching function.

2 Search for unit Bluetooth devices, such as “Carkit_blink” .

3 When connect the mobile phone, please input corresponding PIN code, such as“0000”.

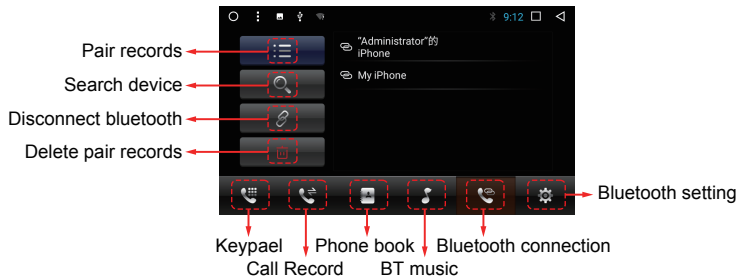

Dialling

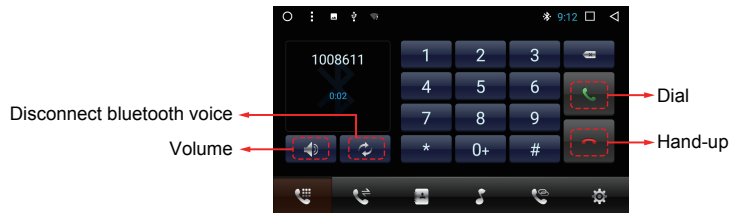

Phonebook

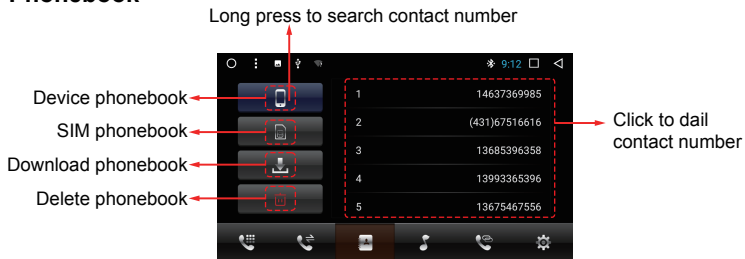

★Bluetooth operation

Call Records

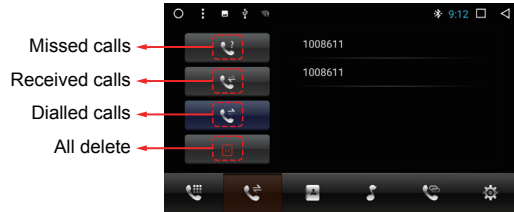

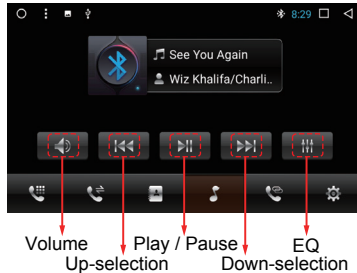

BT Music



★Music/Video operation

The unit support music, video display in device storage and portable storage such as USB and SD.

After insert USB or SD card, the unit will automatically detect and enter the multimedia playback mode. The unit will analyze all the files in USB and SD card and classify the file based on the file extension into music, video categories.

If the current USB or SD card is ready, click Video icon “” or Music icon “” on the main menu also can enter the playback interface.

1. Video Playback

The unit can support variety of video formats, supported video format as follow: AVI, MP4, M4A, MPG, MPEG, DAT, VOB, 3GP, M2V, 3G2, M4V, OGM, RM, RMV, RMVB, FLV, MKV, MOV, TS, M2TS, MFS, ect.

2. Music Playback

The unit can support variety of audio formats, supported video format as follow: MP3, AC3, AAC, RA, RAM, RMM, PCM, WAV, MP1, MP2, FLAC, APE, OGG, ect.

Note: This unit mainly support FAT32 file format.

★ Music/Video operation

USB/SD Music

The unit can support varieties of audio formats, supported video format as follow: MP3, AC3, AAC, RA, RAM, RMM, PCM, WAV, MP1, MP2, FLAC, APE, OGG, ect.

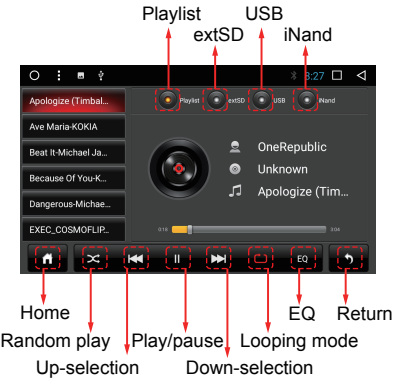

USB/SD Video

The unit can support varieties of video formats, supported video format as follow: AVI, VID, DIVX, ASF, MP4, M4A, MPG, MPEG, DAT, VOB, 3GP, M2V, 3G2, M4V, OGM, RM, RMV, RMVB, FLV, MKV, MOV, TS, M2TS, MFS, ect.



★ System setting

Click “” to enter system setting interface.

■ Wireless & networks

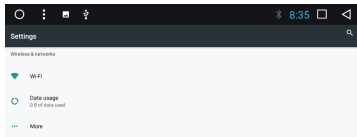

1. Wi-Fi

Select one wifi signal and input wifi signal password, the unit will connect wifi automatically.

You also can add a new wifi address or refresh wifi signal

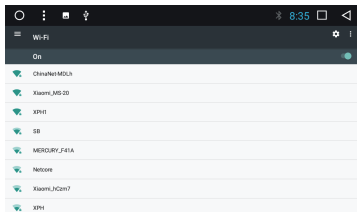

2. Usage

Overview today's wifi usage or view all the wifi usage overall period of time.

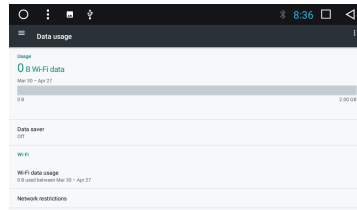

3. More

Turn on or turn off airplane mode Connect or set up hotspot internet

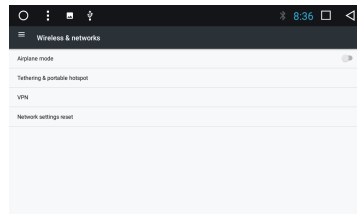

★ System setting

■ Device

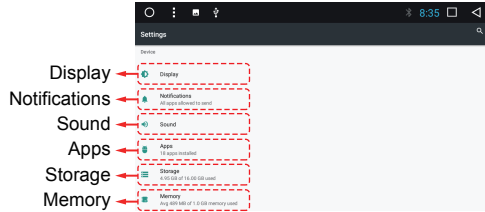

1. Display

Click “” to set up visual effect and system font size.

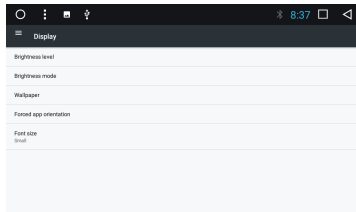

2. notifications

Click “” to set up sound general settings including hint tone and notification, etc.

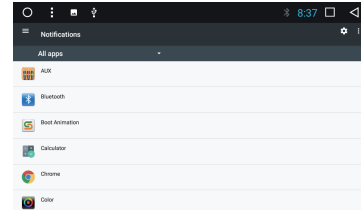

3. Sound

Click “” to set up sound general settings including hint tone and notification, etc.

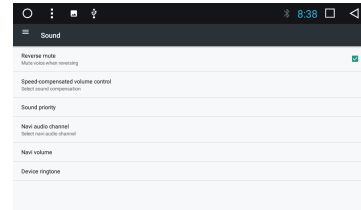

★ System setting

4. Apps

Click “” to view all installed apps information. You can uninstall or force stop any apps in this interface.

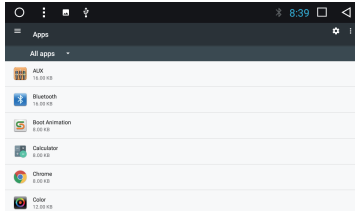

5. Storage

Click “” to set up default write disk as internal storage or USB storage. User also can view device storage and portable storage information in this interface.

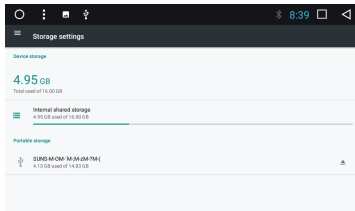

6. Memory

Click “” to view device memory.

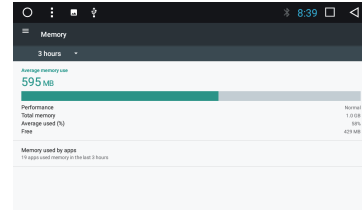

■ Personal

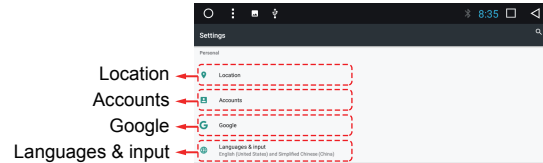

location: Click to set up location mode and corresponding Apps's location permissions.

Accounts: User can add new accounts in this interface.

Google: User can set up location, security and nearby of google service.

Language&Input: User can set up language and keyboard, ect.

★ System setting

■ System

- Date & time
- Developer options
- Car settings
- About device

1. Date & time

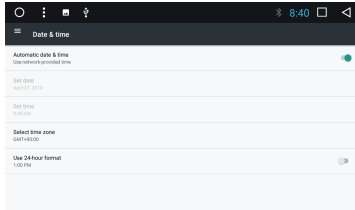
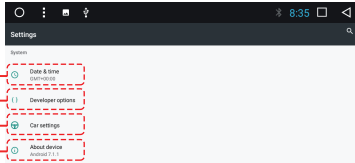

2. Developer options

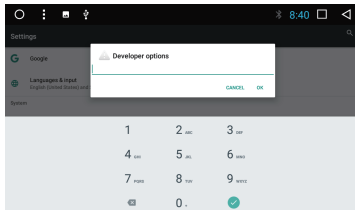

3. Car settings

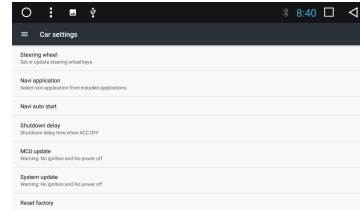

- 1) Steering wheel: Set or update steering wheel keys
- 2) Navi application: Select navi application from installed applications
- 3) Navi auto start: Turn on or turn off Navi auto start
- 4) Shutdown delay: You can choose No delay, Delay 10min, Delay 30min or Delay 1hour
- 5) MCU update
- 6) System update
- 7) Reset factory
- 8) Extra settings: You can set up Panel keys, Radio region, Brake setting, Canbus type ect.

★ System setting

4. About device

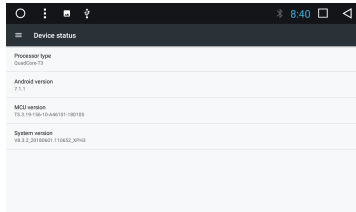

★ Operation

■ File management

During main menu, click “” to enter file management interface. File browser, manage the file of unit and external device.

ES File

Explorer setting

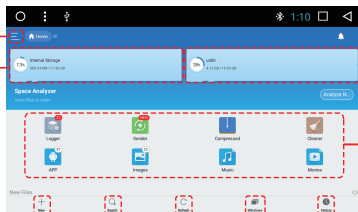

Click to manage the file in the unit

Click to manage the file in SD/USB card

Manage online file

File/Folder Create Search Refresh Windows History

■ Steering wheel

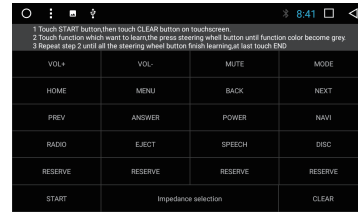

Please set your steering wheel control function according to the following steps.

1. During steering wheel control interface, click “ CLEAR ” button to clear the former settings.
2. Hold down a button on the steering wheel which is needed to set.
3. Click the corresponding function button on the screen.
4. When the button turns blue light, indicating that this button has been set successfully.
5. Repeat 3-5 steps to complete all the keys steering wheel control setting.

★ Operation

■ GPS Test

Click“  ” to enter GPS signal interface. After install GPS antenna, it can detect the GPS signal work good or not.

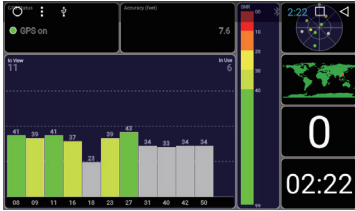

■ Navigation

Click“  ”to enter Navigation interface, after select navigation path, click it will enter corresponding map.

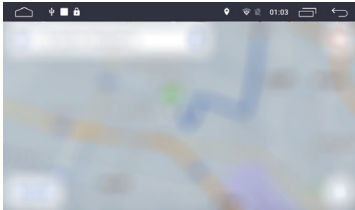

■ Chrome

Unit can connect Internet through 4G SIM card, Wifi, and cell phone hot spots. After connect internet, Click“  ” enter browser interface, input URL to open your favorite website.

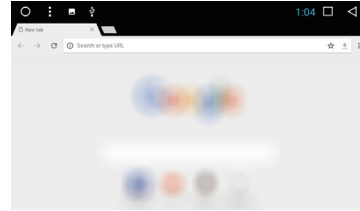

★ Operation

■ Sound Equalizer

Click “” on setting interface or click EQ icon during every model. You can select six preset EQ modes. Or customize your favorite EQ setting by dragging Bass/Middle/Treble/BassF/MiddleF/TrebleF.



Sound zone

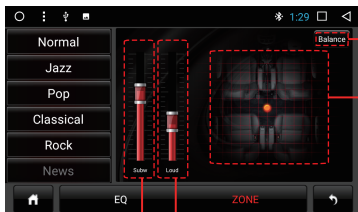

Subwoofer Loud

■ AVIN operation

The unit support audio/video(A/V) Input. Please operate as follow:

1. Connect the external audio/video devices through AV input wires of the unit.
2. Click “” on the main menu to switch to audio and video input mode.

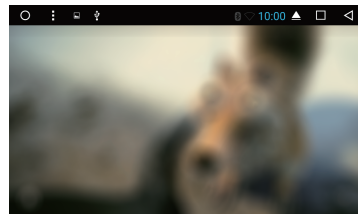

The monitor will display when connected with external equipments.

★ Operation

■ Mirror Link

On main menu, click “” to enter mirror link interface.

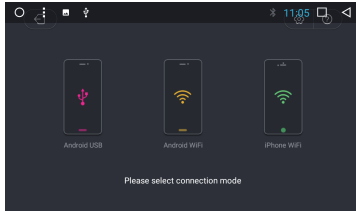

iPhone WIFI

1. Turn on iPhone hotspot, the hotspot will display on the left hand of screen
2. Select the hotspot and input password to connect to iPhone hotspot
3. Slide up control bar and turn on AirPlay, after that iPhone WIFI mirror link will start work



Android USB

1. Enter mobile setting → Developer Option → Turn on USB debug
2. Click Android USB icon, use USB cable to connect with both unit and mobile
3. After install mobile interconnection service, Android USB will start working.

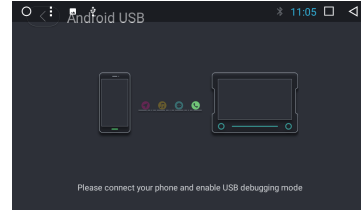

Android WIFI

1. The first time to use Android WIFI, please use USB cable to connect both unit and mobile (The connecting way is same as Android USB)
2. After connect successfully, take apart of USB cable.
3. Turn on android mobile hotspot, the hotspot name will be displayed on the left side of screen
4. Click and connect to the hotspot, after that Android WIFI mirror link will start work

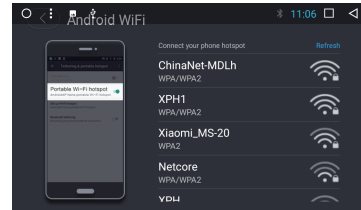

★ Troubleshooting

Note: Please check “troubleshooting list” carefully before sending the broken device back to repair, also take appropriate measures to check or adjust simply. If the problem is out of list or still could not solve the problem, please feel free to contact our professional after-sale team!

Phenomenon	Cause	Solutions
No power supply	Wrong connection between wires and connector	Make sure all connections correct again
	Broken fuse	Find out the reason of the Broken fuse; and then replace it with the identical fuse
	The build-in microprocessor is unable to work normally due to the noise and other factors	
Failure of remote control even if you press the right Remote control button on the unit still does not normal operation.	Low Battery	Replace with new batteries
	Certain functions are forbidden under specific modes	Enter the proper mode
Unable play the disk	Disk is dirty	Clean the disk
	The format of the disk is not compatible	Check the disk format
	The disk video system is not compatible	Change new disk is compatible with the video system
	Disk poor quality or damage	Replace the good quality disk

Phenomenon	Cause	Solutions
No sound	The cable is not properly connected	Re-connect the cable properly
Cannot increase the volume	The machine is running in still, slow motion or frame by frame playback	There is no sound output in still, slow motion or frame by frame playback
Particular Speaker cannot output sound	Audio setup is not corrected	Set the proper audio configuration
The DVD cannot display if appear the parent lockup message	Turn on the parent lockup function	Close the parent lockup function or change the setting level
Unable to Change Language (subtitle included)	Current DVD has no extra languages for selection	You can not switch to other language in a None Multi-Language disc
No subtitled	You can only switch it over to the options as shown in the disk menu	Use the disk menu for switchover
	No subtitle in this DVD	If there are no subtitles recorded for the disk, then it is unable to show subtitles.
	You can only switch it over to the options as shown in the disk menu	Use the disk menu for switchover
Failed to play back according to language in audio and subtitle selected in the DVD SETUP MENU unable to switch over to another viewing angle	The current DVD has no audio or subtitle language in the DVD SETUP MENU	If the disc is not recorded DVD SETUP MENU choice language, is unable to switch to select language

★Troubleshooting

Phenomenon	Cause	Solutions
Unable to view angle switch	The current DVD has no a multi-viewing angle	if the disc is not recorded with more perspective shooting scenes, can not switch to other viewing in a NO Multi-viewing disc
	You try to switch it over to another viewing angle out there are no multi-viewing	Watch with more perspective recording scene switching angle
Picture is extremely unclear distorted or dim in the playback	The disc has a copy protection signal(some of the disc may have this feature)	Because the DVD and anti copy analog copy protection system, so if the player has a copy protection signal disc, then in some viewed on a monitor, the picture may appear horizontal strip or other, it does not mean that the issue of fault.
No image: PIC OFF is shown	You fail to connected the manual brake wires or fail to turn on the manual brake	Connect the brake wire and when turn on the manual brake
When the ignition switch is urned to the ON position (or to the ACC position) the player automatically switches on		This is a normal function